

NC4 non-contact tool setting range

www.renishaw.com/nc4

Specification

Principal application		High-precision, high-speed non-contact tool setting and tool breakage detection on all sizes of vertical and horizontal machining centres, multi-tasking machines and gantry machining centres.
Transmission type		Hard-wired transmission
Compatible interface		NCi-6
Repeatability		±1.0 µm (39.37 µin) 2σ
Tool setting and tool breakage detection (minimum tool or feature size)		Ø0.03 mm (0.0012 in) or larger depending on separation and set-up
Output signal (from interface unit)		Two voltage-free, solid-state relays (SSR). Each can be either normally open or normally closed (selectable via a switch). Current (max.) 50 mA, voltage (max.) ±50 V. The interface contains an auxiliary relay which can be used for switching the output between the NC4 and a spindle probe. This relay can also be used to control an air blast solenoid (optional).
Supply voltage (to interface)		11 Vdc to 30 Vdc
Supply current (to interface)		120 mA @ 12 Vdc, 70 mA @ 24 Vdc
Supply protection		Resettable fuses in interface. Reset by removing power and cause of fault.
Electrical connection arrangement (Other configurations are available on request.)		Hard-wired systems: cable on the end of the unit Systems with connector: connector socket
Cable (to interface)	Specification	Ø6.0 mm (0.24 in) , two twisted pairs, two individual cores plus screen, each core 18 × 0.1 mm insulated
	Length	12.5 m (41.01 ft)
	Electrical connection	Hard-wired systems: cable on the end of the unit. Systems with connector: cable with bayonet-type cable plug, connector socket on the end of the unit. Other configurations are available on request.
NC4 pneumatic supply		Hard-wired systems: Ø3.0 mm (0.12 in) × 5.0 m (16.40 ft). Systems with connector: Ø4.0 mm (0.16 in) × 5.0 m (16.40 ft). Air pipe, 6.0 bar (87.02 psi) maximum. Air supply to the NC4 must conform to BS ISO 8573-1: 2010 Class 1.4.2.
Air blast pneumatic supply		Ø6.0 mm (0.24 in) air pipe × 5.0 m (16.40 ft), 6.0 bar (87.02 psi) maximum. Air supply to the air blast must conform to BS ISO 8573-1: 2010 Class 2.9.4.
Laser type		Class 2 laser product: NC4 (red laser) – 1 mW maximum output emitted wavelength 670 nm. NC4+ Blue (blue laser) – 1 mW maximum output emitted wavelength 405 nm. WARNING: Laser radiation. Do not stare into beam.
Laser beam alignment		The unit is supplied with an adjustable mounting plate on the underside.
Weight (including 12.5 m (41.01 ft) of cable).		1080 g (2.38 lb) to 2000 g (4.4 lb) depending on configuration.
Sealing		IPX6 and IPX8, BS EN 60529:1992+A2:2013 (IEC 60529:1989+A1:1999+A2:2013)
Mounting (Alternative fixing arrangements are available on request.)		M4 (3 off), M10 (3/8 in) or M12 (1/2 in) bolts for mounting via adjuster plate (not supplied)
Storage temperature		–25 °C to +70 °C (–13 °F to +158 °F)
Operating temperature		+5 °C to +55 °C (+41 °F to +131 °F)

NC4 hard-wired system dimensions

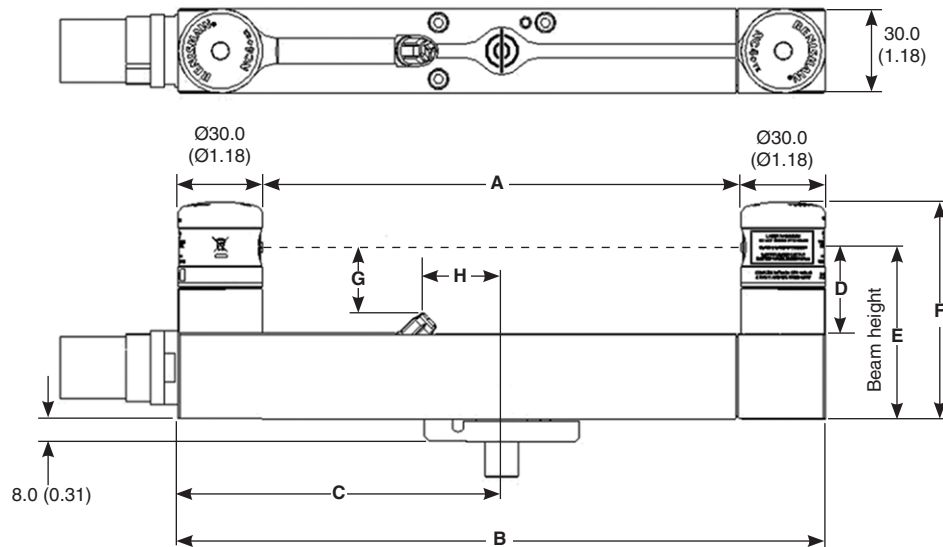

Model	Blue laser	Red laser	Dimensions							
			A	B	C	D	E	F	G	H
F115		✓	55.0 (2.17)	115.0 (4.53)	57.5 (2.26)	31.0 (1.22)	61.0 (2.40)	77.0 (3.03)	18.0 (0.71)	13.7 (0.54)
F115 (raised)		✓	55.0 (2.17)	115.0 (4.53)	57.5 (2.26)	50.0 (1.97)	80.0 (3.15)	96.0 (3.78)	35.6 (1.40)	12.6 (0.50)
F145		✓	85.0 (3.35)	145.0 (5.71)	72.5 (2.85)	31.0 (1.22)	61.0 (2.40)	77.0 (3.03)	20.4 (0.80)	24.5 (0.96)
F145 (raised)		✓	85.0 (3.35)	145.0 (5.71)	72.5 (2.85)	50.0 (1.97)	80.0 (3.15)	96.0 (3.78)	37.5 (1.48)	25.0 (0.98)
F230		✓	170.0 (6.69)	230.0 (9.06)	115.0 (4.53)	31.0 (1.22)	61.0 (2.40)	77.0 (3.03)	21.3 (0.84)	25.3 (1.00)
F230 (raised)		✓	170.0 (6.69)	230.0 (9.06)	115.0 (4.53)	50.0 (1.97)	80.0 (3.15)	96.0 (3.78)	40.3 (1.59)	44.3 (1.74)
F300		✓	240.0 (9.45)	300.0 (11.81)	150.0 (5.91)	31.0 (1.22)	61.0 (2.40)	77.0 (3.03)	21.4 (0.84)	25.4 (1.00)
F300 (raised)		✓	240.0 (9.45)	300.0 (11.81)	150.0 (5.91)	50.0 (1.97)	80.0 (3.15)	96.0 (3.78)	40.4 (1.59)	44.4 (1.75)

Dimensions in mm (in)

NC4 straight connector dimensions

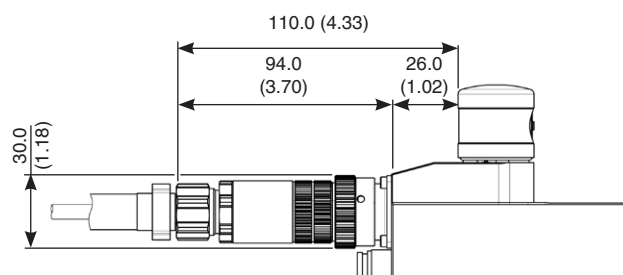

Dimensions in mm (in)

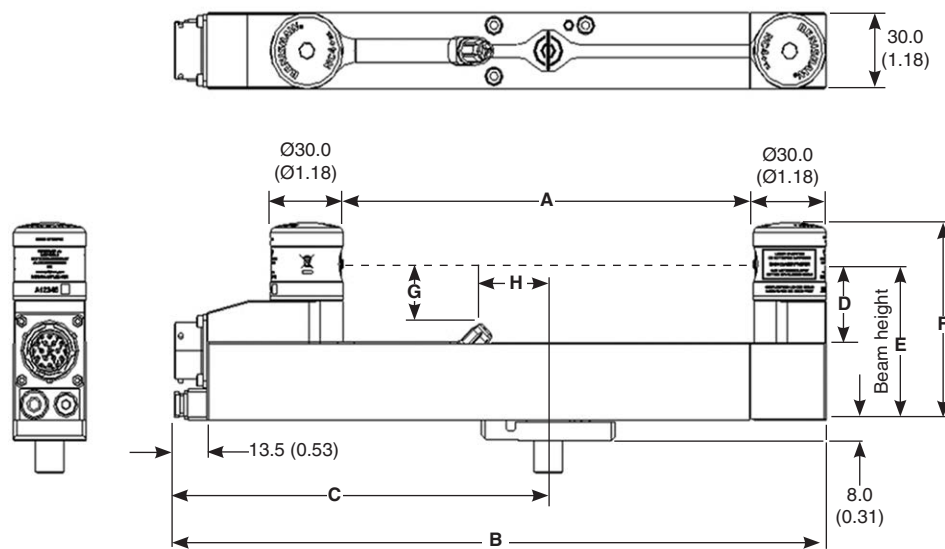

Model	Blue laser	Red laser	Dimensions							
			A	B	C	D	E	F	G	H
F115C	✓	✓	55.0 (2.17)	155.0 (6.10)	97.3 (3.83)	31.0 (1.22)	61.0 (2.40)	77.0 (3.03)	18.1 (0.71)	13.8 (0.54)
F115C (raised)	✓	✓	55.0 (2.17)	155.0 (6.10)	97.3 (3.83)	50.0 (1.97)	80.0 (3.15)	96.0 (3.78)	35.1 (1.38)	12.3 (0.48)
F145C	✓	✓	85.0 (3.35)	185.0 (7.28)	112.3 (4.42)	31.0 (1.22)	61.0 (2.40)	77.0 (3.03)	21.3 (0.84)	25.3 (1.00)
F145C (raised)	✓	✓	85.0 (3.35)	185.0 (7.28)	112.3 (4.42)	50.0 (1.97)	80.0 (3.15)	96.0 (3.78)	37.1 (1.46)	24.7 (0.97)
F230C		✓	170.0 (6.69)	270.0 (10.63)	155.0 (6.10)	31.0 (1.22)	61.0 (2.40)	77.0 (3.03)	21.3 (0.84)	25.3 (1.00)
F230C (raised)		✓	170.0 (6.69)	270.0 (10.63)	155.0 (6.10)	50.0 (1.97)	80.0 (3.15)	96.0 (3.78)	40.3 (1.59)	44.3 (1.74)
F300C		✓	240.0 (9.45)	340.0 (13.39)	190.0 (7.48)	31.0 (1.22)	61.0 (2.40)	77.0 (3.03)	21.3 (0.84)	25.3 (1.00)
F300C (raised)		✓	240.0 (9.45)	340.0 (13.39)	190.0 (7.48)	50.0 (1.97)	80.0 (3.15)	96.0 (3.78)	40.3 (1.59)	44.3 (1.74)

Dimensions in mm (in)

NC4 90° connector dimensions

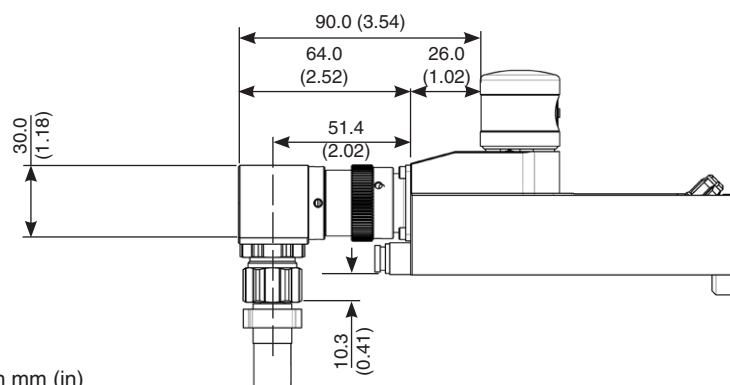

Dimensions in mm (in)

NC4 adjuster plate mounting and dimensions

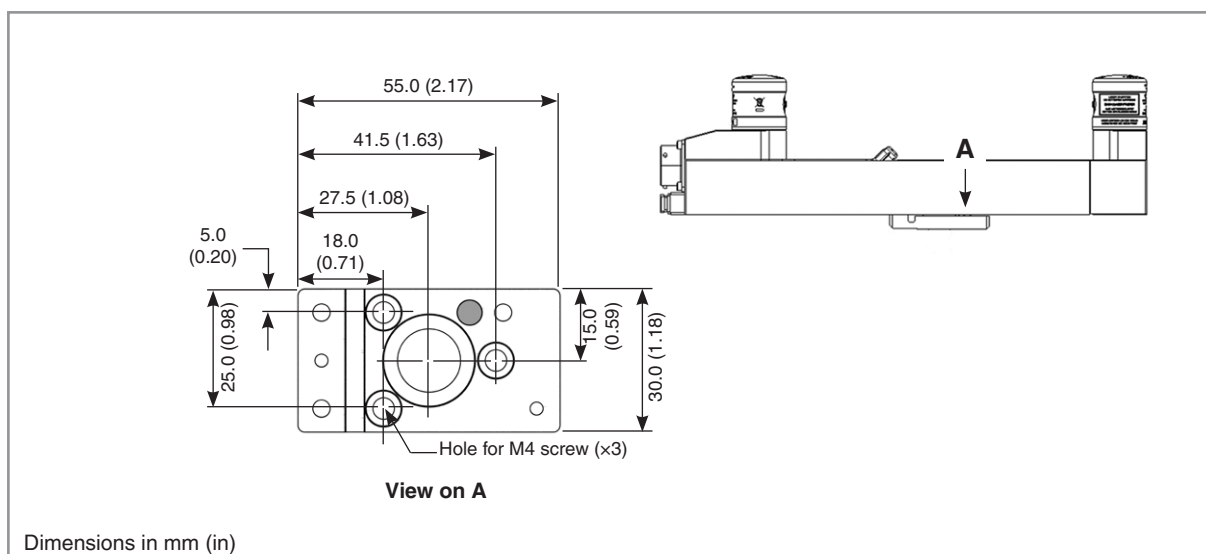

Electro-pneumatic integration

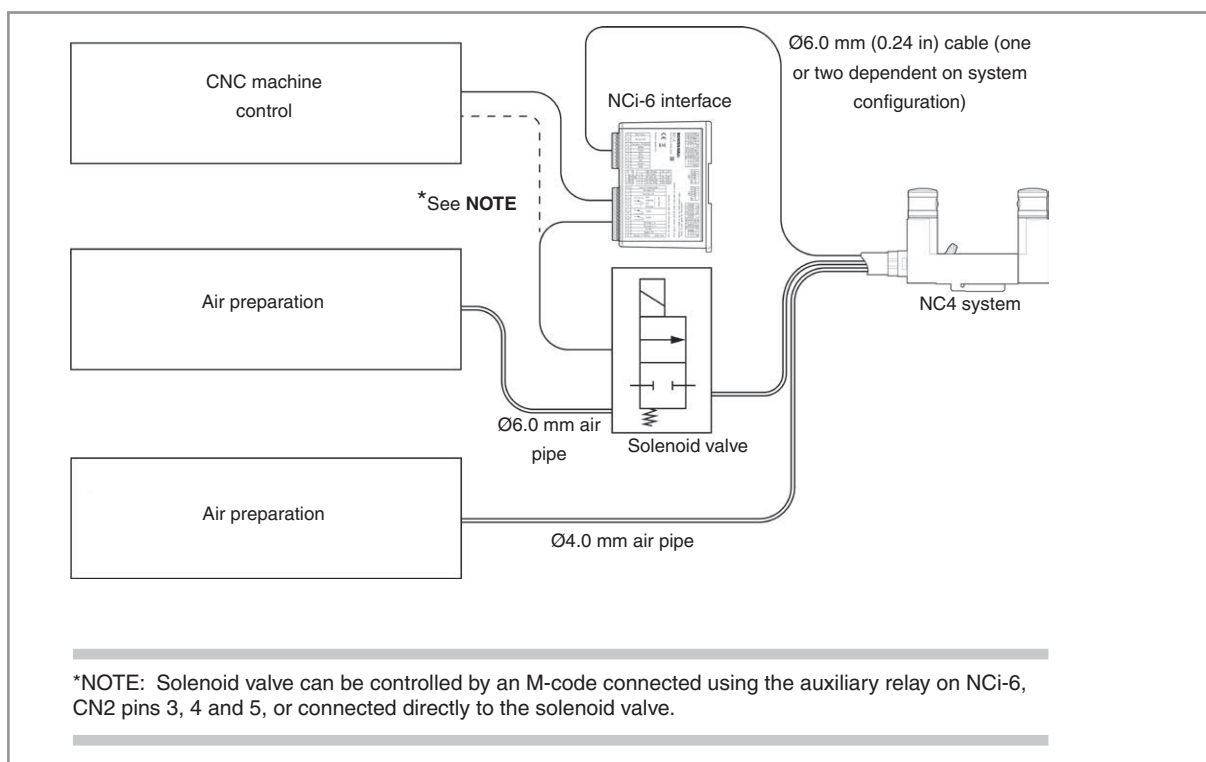

Spare parts and accessories

A full range of spare parts and accessories is available.
Please contact Renishaw for a full list.

For worldwide contact details, visit www.renishaw.com/contact

RENISHAW HAS MADE CONSIDERABLE EFFORTS TO ENSURE THE CONTENT OF THIS DOCUMENT IS CORRECT AT THE DATE OF PUBLICATION BUT MAKES NO WARRANTIES OR REPRESENTATIONS REGARDING THE CONTENT. RENISHAW EXCLUDES LIABILITY, HOWSOEVER ARISING, FOR ANY INACCURACIES IN THIS DOCUMENT.

